

Manila Waterways Urban Redevelopment Plan

24.April.2012

This is not an ADB material. The views expressed in this document are the views of the author/s and/or their organizations and do not necessarily reflect the views or policies of the Asian Development Bank, or its Board of Governors, or the governments they represent. ADB does not guarantee the accuracy and/or completeness of the material's contents, and accepts no responsibility for any direct or indirect consequence of their use or reliance, whether wholly or partially. Please feel free to contact the authors directly should you have queries.

PALAFox[®]



Proposed Maestranza Redevelopment and the existing site



Proposed Escolta Ferry Terminal



Quinta Market Redevelopment and River Park



Proposed Sta. Ana Market Redevelopment



Proposed Muelle del Rio and the existing site



Proposed Bgy. San Agustin Urban Renewal and the existing site



Proposed Marcelo Street Redevelopment and existing site



Proposed Quiapo Urban Renewal and the existing site



Pasig River Rehabilitation

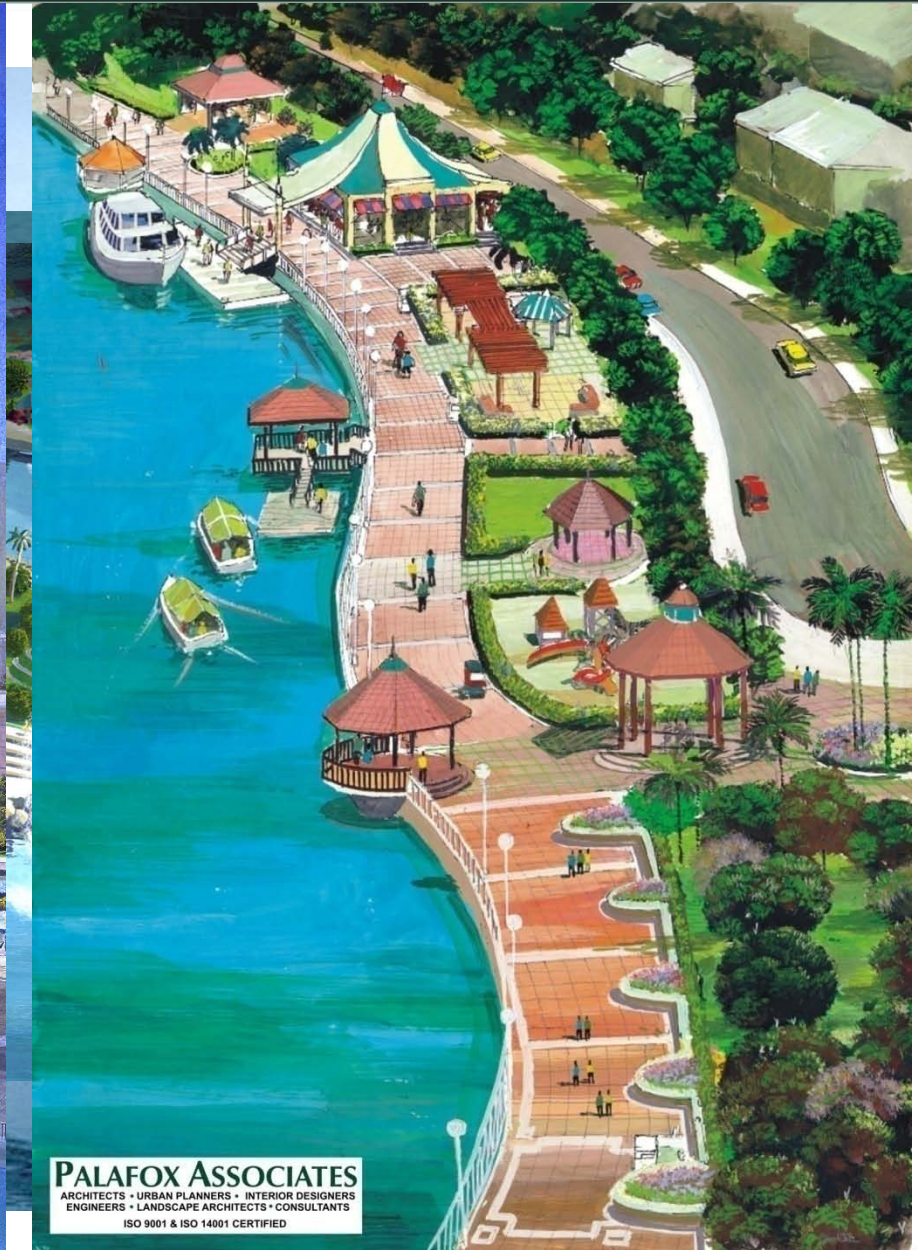

PALAFox ASSOCIATES
ARCHITECTS • URBAN PLANNERS • INTERIOR DESIGNERS
ENGINEERS • LANDSCAPE ARCHITECTS • CONSULTANTS
ISO 9001 & ISO 14001 CERTIFIED

PALAFox

Estero de Paco Linear Park — Segment 2



MANILA WATERWAYS PHASE - 2
OSMENA BRIDGE TO QUIRINO BRIDGE
END OF PROJECT LIMIT

LEGEND	
	ACTUAL WATERWAY
	WATER SURFACE 15-17m asl
	SPILLWAY
	NATURAL GRADE w/ SLOPE
	ACTUAL EMBANKMENT
	EXISTING RIPRAP
	PAVEMENT
	RECYCLED PAVERS

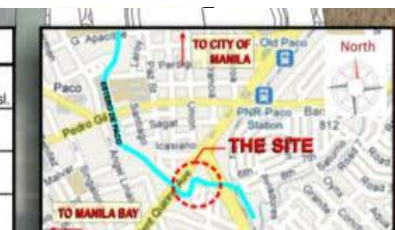

ENVIRONMENT / PLANET EARTH

REDUCING
ECOLOGICAL
FOOTPRINT

SUSTAINABLE
DEVELOPMENT
PRACTICES

LIFE CYCLE
ASSESSMENT OF
MATERIALS



CORPORATE SOCIAL
RESPONSIBILITY

REVENUE
STREAMING

ECONOMY PROFIT

SUSTAINED
ECONOMIC
IMPACT ON THE
ECONOMIC
ENVIRONMENT

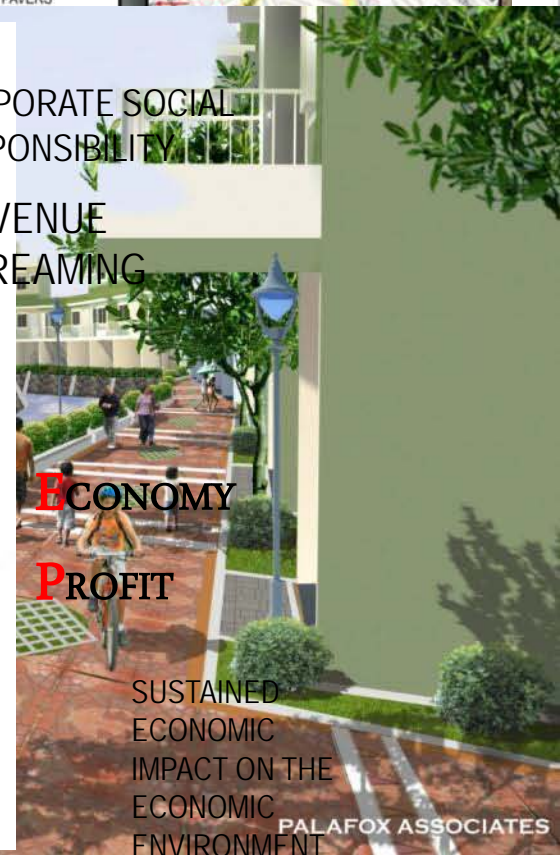

PALAFox ASSOCIATES



MANILA WATERWAYS PHASE - 2
OSMENA BRIDGE TO QUIRINO BRIDGE
END OF PROJECT LIMIT

Estero de Paco from Quirino Bridge



GRASS PAVERS



RECYCLED PAVERS



BOUGAINVILLEA
Bougainvillea Spectabilis



KALATSUTSI
Plumeria Rubra

PALAFox



OPTION 2 - CARNEIMERICAL

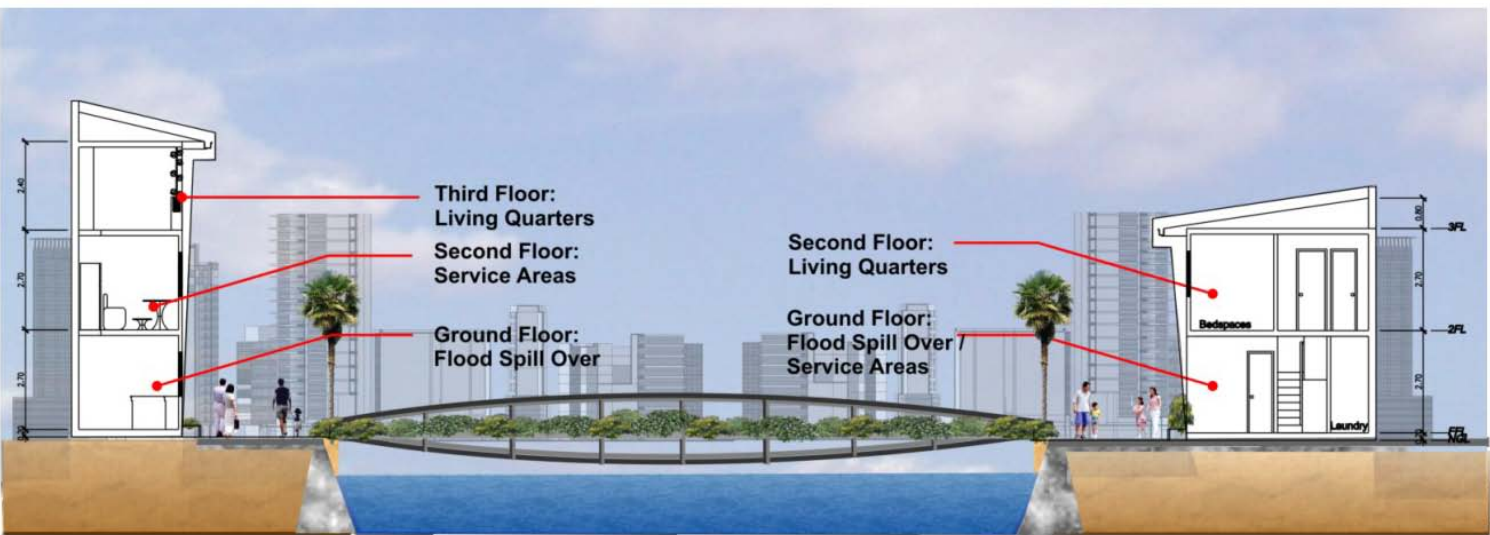

Typical Section

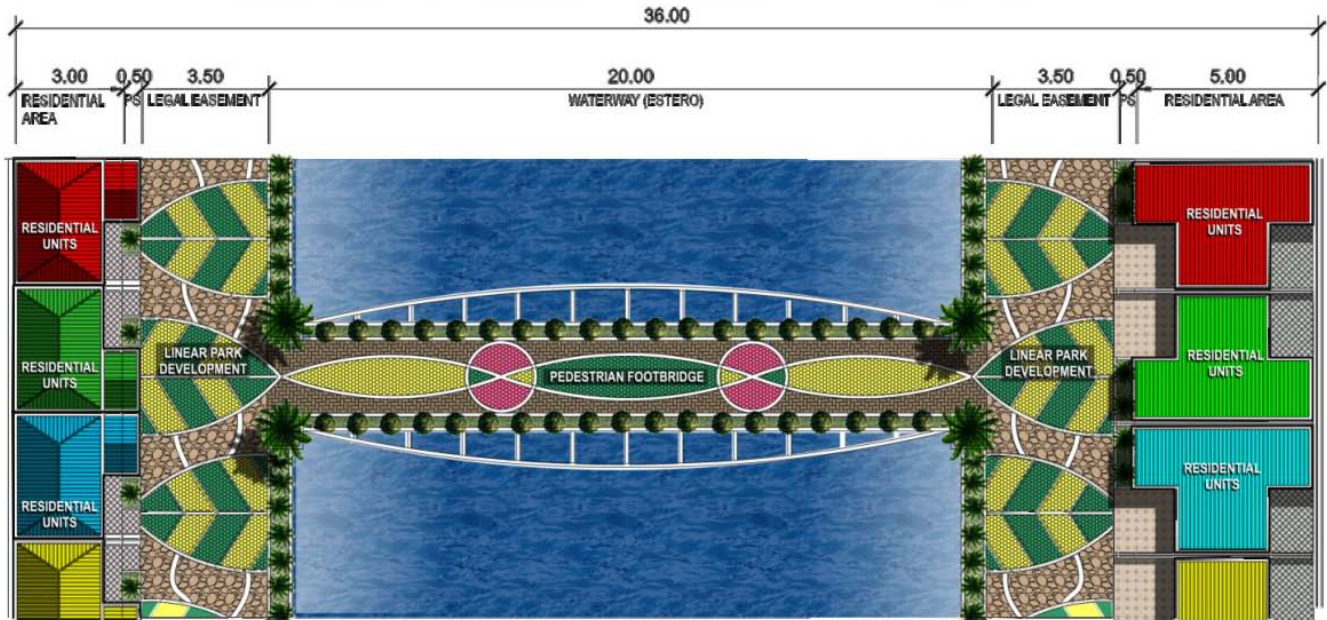

ESTERO DE SAN MIGUEL - AREA 1 TYPICAL PLAN

Estero de San Miguel Typical Plan





OPTION 3 – CONTAINERIZATION



Perspective – Recycled Container Vans

From the architects, urban planners, interior designers, engineers, environmental designers, and management of PALAFOX
ASSOCIATES,



Thank You!